



SERIES 6500 Counter Shutter



Security and beauty blended with smooth, quiet and effortless operation, the C.H.I. Series 6500 counter shutter is a wonderfully refined, architecturally pleasing enclosure.

FEATURES:

- The Model 6544 features a clear anodized, extruded aluminum curtain and guides.
- The Model 6522 features a painted steel curtain with clear anodized, extruded aluminum guides.
- The Model 6566 features a stainless steel curtain with a #4 finish and stainless steel "J" guides.
- Blemish-free exterior: The Models 6544 and 6522 feature hidden headplates, guides and wall fasteners for a well-blended, architecturally sensitive appearance.
- Visible seams and shadow lines are eliminated from extruded aluminum guides due to unique joint designs.
- Soft brush guide runners silence curtain operation and seal out dust and noise.
- Dual-bottom bar seal assures a soft, non-marring touch down to valuable counter tops.
- Thumb turn locks are spring assisted, and secure each side of the bottom bar into hidden recesses in the guides. Cylinder locking is optional for each side.
- Integral lift rails on the bottom bar provide full-width manual access and simplified lifting.
- Invisible tubular motor operation, awning crank operation, or exterior mount motor is optional.
- Compact in design, the Series 6500 installs into minimum head and side room dimensions.



Optional high torque tubular motor for non-visible, dependable operation.

SPECIFICATIONS

PART 1 - GENERAL

1.01 WORK INCLUDED: Rolling counter shutters to be C.H.I. Series 6500.

1.02 RELATED SECTIONS:

- a. Section 04200 Concrete Block
- b. Section 05500 Metal Fabrications
- c. Section 06100 Wall Construction
- d. Section 08300 Access Doors
- e. Section 09900 Painting
- f. Section 16000 Electrical

1.03 SUBMITTALS:

- a. Furnish all submittals according to guidelines of Division 1 Submittal Procedures.
- b. Shop Drawings: Furnish shop drawings for architectural approval including elevations and details showing dimensions, finishes, profiles and sections for each door.
- c. Product Literature: Submit manufacturer's brochures and literature describing product to be used.
- d. Provide manufacturer's installation instructions.

1.04 DELIVERY, STORAGE AND HANDLING:

- a. Refer to Division 1 Material Storage and Handling Requirements.
- b. Deliver and store all materials in manufacturer provided packaging and protect from damage in a safe and dry location.

1.05 WARRANTY: Provide manufacturer's standard five-year warranty from date of plant shipment against defects in materials and workmanship.

PART 2 - PRODUCTS

2.01 GENERAL: Items and components described in the following paragraphs reflect current products manufactured by C.H.I. Overhead Doors, Inc. P.O. Box 260, Arthur, Illinois, 61911, and may be changed without notice by the manufacturer without penalty or liability.

2.02 CURTAIN: Extruded, interlocking aluminum slats, interlocking roll-formed slats in 22-gauge steel, or interlocking roll-formed slats in 22-gauge stainless steel. Lateral slat movement and curtain wear controlled by nylon endlocks fastened to every other slat. Windlocks added as dictated by shutter size and windload requirements. Slat profile is 1-1/2 inches high by 1/2 inch deep.

2.03 BOTTOM BAR: Extruded aluminum with integral lift rails and dual bottom astragal standard for aluminum and steel curtains. Stainless steel angle with bottom astragal provided for stainless curtains.

2.04 GUIDES: Extruded, clear anodized aluminum. Box shaped, two-piece configuration with soft brush guide runners, bell mouths and travel stops. Guides for stainless steel are box shaped, #4 stainless steel with integral bell mouths and curtain stops.

2.05 HEADPLATES: Headplates for mounting curtain, hood, and barrel assemblies fabricated from steel plate. Drive axle supported by precision, self-aligning bearings.

2.06 BARREL: Barrel constructed from minimum 4-1/2 inch O.D. steel pipe. Deflection under full load not to exceed 0.03 inches per foot of span. Barrel provided with threaded rings or lugs welded to barrel assembly for curtain attachment.

2.07 SPRINGS: Spring (tension) end of barrel assembly fabricated with self-aligning ball bearing assembly to support barrel assembly. Curtain weight counterbalanced by oil-tempered, helically wound torsion springs, grease packed and mounted on steel torsion shaft.

2.08 HOOD: Rectangular hood formed of minimum 24-gauge steel, aluminum or stainless steel sheet, shaped to fit within headplates. Intermediate hood support(s) furnished as required.

2.09 LOCKING: Manual push-up doors furnished with thumb turn locks. Stainless steel slide locks provided with stainless curtains. Keyed thumb turn and cylinder locking optional.

2.10 OPERATION: Manual push up. Reduced drive awning crank operation, concealed tube motor operation and outside motor operation optional.

2.11 FINISHES: Extruded aluminum curtain, guides and bottom bar to be clear anodized. Steel curtain slats and hood hot-dipped galvanized, per ASTM A-653, G-90, with baked epoxy primer and polyester finish coat in gray and white. Painted curtains furnished with clear anodized extruded aluminum box guides and bottom bar. Stainless shutters furnished with #4 polished finish curtain, guides and bottom bar. Powder-coating optional for all steel and aluminum components.

PART 3 - EXECUTION

3.01 EXAMINATION:

- a. Examine site and notify architect of non-specified conditions or construction.
- b. Advise procedures and corrections necessary to accommodate installation.

3.02 INSTALLATION: C.H.I. rolling steel doors shall be installed and adjusted according to C.H.I. assembly instructions by trained door systems technicians.

3.03 CLEANING AND PRESENTATION:

- a. Clean all finished surfaces after installation for a factory original appearance.
- b. Replace any damaged components before final inspection.
- c. Remove all packaging and debris from installation area at the completion of installation.
- d. Present operation and maintenance instructions to owner after demonstrating proper care and operation of door.

HEADER CLEARANCES & DIMENSIONS (INCHES)

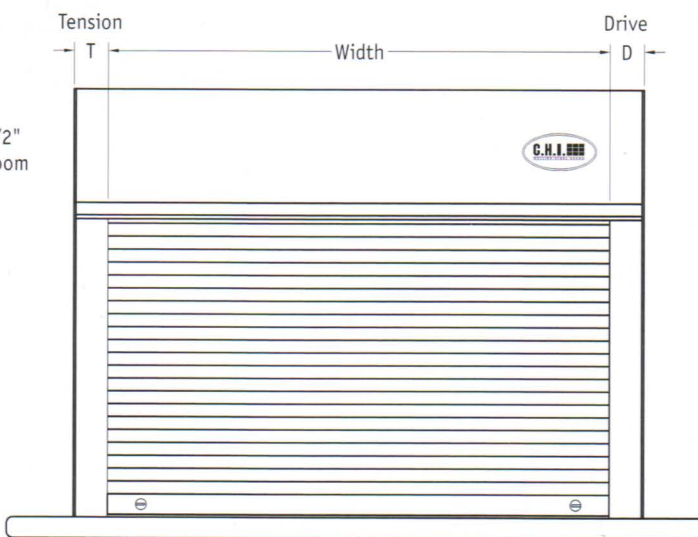
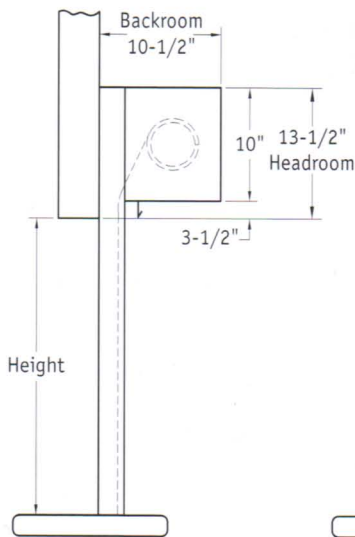

Face of Wall Mount
Aluminum & Steel

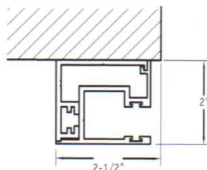

	D	T
Manual	2-1/2"	2-1/2"
Awning Crank	4-1/2"	2-1/2"
Motor	2-1/2"	2-1/2"

Between Jamb Mount
Aluminum & Steel

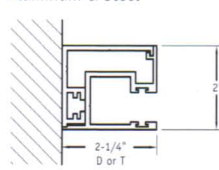

	D	T
Manual	2-1/4"	2-1/4"
Awning Crank	4-1/4"	2-1/4"
Motor	4-1/4"	2-1/4"

Face of Wall Mount
Stainless Steel

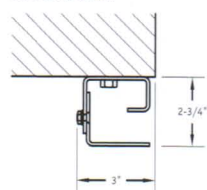

	D	T
Manual	3-1/2"	4-1/2"
Awning Crank	5"	4-1/2"
Motor	5"	4-1/2"

Between Jamb Mount
Stainless Steel

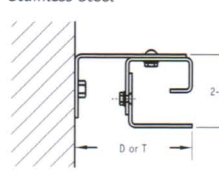

	D	T
Manual	3-1/2"	4-1/2"
Awning Crank	5"	4-1/2"
Motor	5"	4-1/2"