

For easier door specifications or product questions call our Consulting Service 1-866-499-6781.



As the originator of the interlocking slat rolling door, Wayne-Dalton offers a variety of standard slat sizes and designs in galvanized steel, aluminum and stainless steel. Each is designed to meet certain requirements and all have the following characteristics:

- **Reversible, water-shedding design.** Provides a natural water-shed.
- **Free-acting joints.** Are interlocking, yet permit easy articulation when the door coils.
- **Superior quality materials.** To meet or exceed all design criteria.
- **Durability.** Extended operation due to fewer moving parts by design.
- **Strength.** All doors designed to meet minimum 20 PSF windload, using alternate endlocks or windlocks as standard.
- **Space Saving.** Compactness of design at coil enclosure for maximum overhead clearance and free traffic access through and around doors.
- **Colors Available.** White, blue, gray, tan, brown.

GREAT FEATURES THAT MAKE A BETTER BUY:

- 1** Galvanized, pre-painted curtain of minimum 24 gauge steel has interlocking slats with endlocks/windlocks riveted to ends of alternate slats. Designed to withstand 20 PSF windload. Note: Curtains are pre-painted to eliminate "white rust." Windlocks are rugged stamped galvanized steel or malleable iron. Pre-punched top slat holes cut field labor installation costs. See below for curtain options.
- 2** Extra-strong double-angle galvanized bottom bar with astragal is formed of two $\frac{1}{8}$ " minimum thick steel angles and a half-slat. It reinforces lower edge of curtain against wind pressure, and permits varied lock, astragal and safety edge options. Hangs freely on curtain to reduce friction. Preassembled for ease of installation.
- 3** Roll-formed galvanized steel guides are fabricated from precisely formed angles and channels with integral windlock bars. They precisely guide curtain travel, and can withstand windloads to 20 PSF. Groove mouths are provided at top of guides to assure smooth transition of the curtain into the guides.
- 4** Guide stop installs easily, without fasteners protruding into the guide

openings to interfere with door operation. Equipped with removable stops which facilitate entry of curtain into guides during installation.

- 5** Pre-assembled hot dipped galvanized steel brackets support and enclose the curtain coil and spring barrel at either end. Pre-punched for easy installation of hood.
- 6** Counterbalance assembly consists of a spring barrel, which serves as load-carrying beam, encases counterbalance mechanism, and provides axis around which curtain coils. (Deflection is limited to 0.03" per lineal foot of span.) If needed, barrel rings are involute shapes of malleable iron, or stamped steel to assure proper counterbalance for all points of travel. Oil-tempered, torsion-type counterbalance springs are wound from heat-treated steel, provides accuracy in balancing door. Barrel plugs connect ends of springs to barrel and tension rod. Tension rod of steel shafting holds fixed ends of springs and carries torsional load of spring counterbalance.
- 7** Tension adjusting wheel is mounted outside bracket, on end of tension rod. It simultaneously applies and holds tension of counterbalance, makes adjustment simple.
- 8** Sheet metal hood covers curtain coil and counterbalance mechanism. Optional slatted hoods are available to match curtain colors.

900 Series



No. 2—Curved-faced single crown slat is available in up to 20 gauge steel or to 16 B&S gauge aluminum. Depth of crown: $\frac{1}{2}$ ", $1\frac{1}{2}$ " on centers.

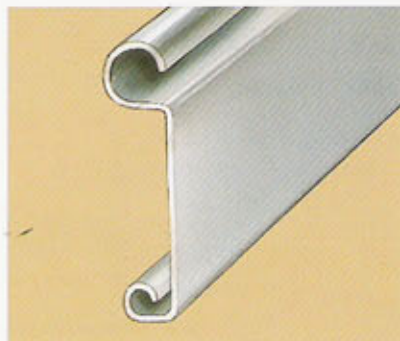

No. 17—Flat-faced slat. Offered in up to 20 gauge steel or to 16 B&S gauge aluminum. Depth of crown: $\frac{1}{2}$ ", $1\frac{1}{2}$ " on centers.

For easier door specifications or product questions call our Consulting Service 1-866-499-6781.

FACE-OF-WALL MOUNTING Manual Operation, Model SDF1

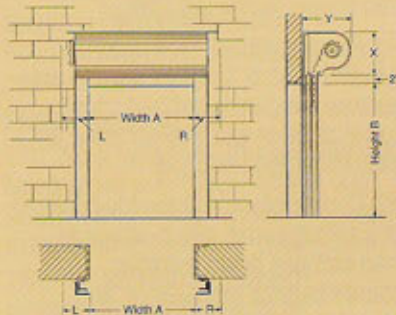

900 Series Doors (2" slats)

Width A	Height B—to 8'0"	
	X & Y	L & R
to 12'0"	14½"	6"

X dimension is bracket height.
Brackets placed 2" (std.) above lintel. Not recommended for sizes exceeding 96 sq. ft.

FACE-OF-WALL MOUNTING Chain Hoist Operation, Model SDF2

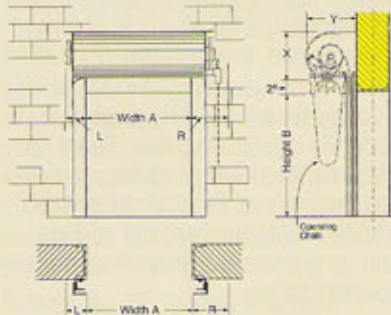

900 Series Doors (2" slats)

Width A	Height B											
	to 11'0"			to 16'0"			to 18'0"			to 22'0"		
	X & Y	L	R	X & Y	L	R	X & Y	L	R	X & Y	L	R
to 16'0"	14½"	6	8	16½"	6	8	18½"	6	8	22	6	8

(Dimensions are in inches)

For larger size doors, consult factory.

FACE-OF-WALL MOUNTING Crank Operation, Model SDF3

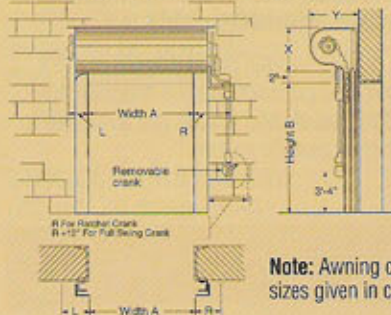

900 Series Doors (2" slats)

Width A	Height B											
	to 11'0"			to 16'0"			to 18'0"			to 22'0"		
	X & Y	L	R	X & Y	L	R	X & Y	L	R	X & Y	L	R
to 16'0"	14½"	6	14	16½"	6	14	18½"	6	14	NOT RECOMMENDED		

(Dimensions are in inches)

For larger size doors, consult factory.

Note: Awning crank available for all doors in sizes given in charts.

FACE-OF-WALL MOUNTING Motor Operation, Model SDF7

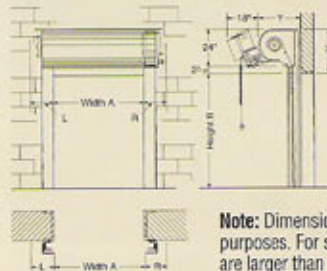

900 Series Doors (2" slats)

Width A	Height B											
	to 11'0"			to 16'0"			to 18'0"			to 22'0"		
	X & Y	L	R	X & Y	L	R	X & Y	L	R	X & Y	L	R
to 16'0"	14½"	6	8	16½"	6	8	18½"	6	8	22	6	8

(Clearances on doors with operator bracket mounted)

(Dimensions are in inches)

Note: Dimensions are for general reference only and not for construction purposes. For special requirements, consult factory. Where door dimensions are larger than the dimensions given within a single bracket in charts, use the data given for the next larger width or height.

MODEL TYPES, DESCRIPTIONS AND CLEARANCES



For easier door specifications or product questions call our Consulting Service 1-866-499-6781.

UNDER-LINTEL BETWEEN-JAMB MOUNTING Manual Operation, Model SDB1

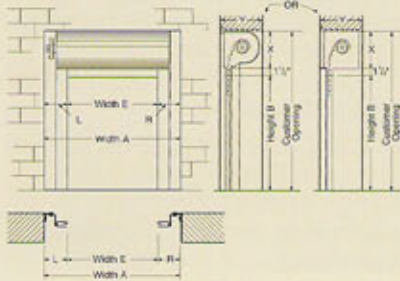

900 Series Doors (2" slats)

		Height B—to 8'0"		
Width A	X & Y	L	R	
to 12'0"	14½"	6"	6"	

Not recommended for sizes exceeding 96 sq. ft.

UNDER-LINTEL BETWEEN-JAMB MOUNTING Chain Hoist Operation, Model SDB2

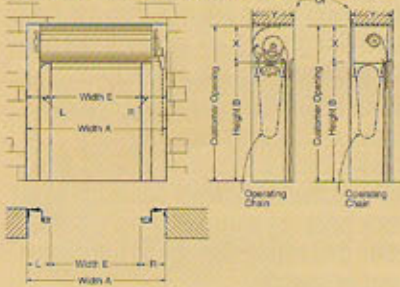

900 Series Doors (2" slats)

		Height B											
		to 11'0"			to 16'0"			to 18'0"			to 22'0"		
Width A	X & Y	L	R	X & Y	L	R	X & Y	L	R	X & Y	L	R	
to 16'0"	14½"	6	9	16½"	6	9	18½"	6	9	22	6	9	

(Dimensions are in inches)

MODEL NO. CHARTS Service Doors—900 Series (2" slats) (Paragraph 1.01 on back)

Face-of-Wall Mount				
Gauge	Manual	Chain	Crank	Motor
24	SDF1PS	SDF2PS	SDF3PS	SDF7PS
22	SDF1PS	SDF2PS	SDF3PS	SDF7PS
20	—	SDF2PS	SDF3PS	SDF7PS

Between-Jambs Mount				
Gauge	Manual	Chain	Crank	Motor
24	SDB1PS	SDB2PS	SDB3PS	SDB7PS
22	SDB1PS	SDB2PS	SDB3PS	SDB7PS
20	—	SDB2PS	SDB3PS	SDB7PS

Add "X" suffix when Air-Bar/Extr-Tite option is applicable.

Slat Specification/Selection Chart (Paragraph 2.01 on back)

	Slat Gauges (A)	Slat Type (B)		Material (C)
		Curved	Flat	
900 Series	24, 22, 20	2	17	Galvanized, bonderized steel with gray, (other colors available) baked-on finish
	22, 20	2	17	Stainless steel
	18 or 16 B&S	2	17	Aluminum

Table below gives guide clearance and standard slats required for doors of various widths.

	Width	A Detail	D	N Min.	N Max.	T
900 Series No. 2 and No. 17 slats	thru 16'0"	1	2.34"	3.09"	4.09"	2.88"
		2	2.64"	3.09"	4.61"	2.88"

Common Guide Mounting Details Detail 1

(Standard up to 18' high on 900 Series.)

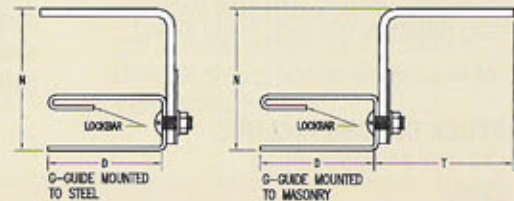

Roll-formed guide is used for slats No. 2 and No. 17.

Detail 2

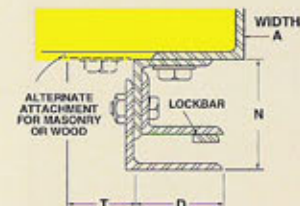

Angle guides if specified, otherwise, roll-formed is standard.



For easier door specifications or product questions call our Consulting Service 1-866-499-6781.

GENERAL SPECIFICATIONS FOR ROLLING SERVICE DOORS

Note to Specifiers:

Words in parentheses indicate frequently specified and highly recommended options.

PART 1 GENERAL

1.01 Work Included—The opening will be equipped with Wayne-Dalton 900 Series rolling doors, Model _____ as manufactured by Wayne-Dalton Corp.

1.02 Related Work—Opening preparation, miscellaneous or structural metal work, access panels, finish or field painting, field electrical wiring, wire, conduit, fuses, and disconnect switches are in the Scope of Work of other divisions or trades.

PART 2 PRODUCT

2.01 Curtain will be composed of interlocking slats (A) gauge, No. (B) slats, roll-formed from (C) per ASTM standards and designed to withstand a 20 PSF windload. Ends of alternate slats will be fitted with metal endlocks/windlocks.

Bottom Bar will consist of 2 equal galvanized steel (stainless steel) (aluminum) angles, minimum 1/2" thick, to stiffen curtain, with loop astragal. When required for additional security, provide (slide bolts) (cylinder locks) on the bottom bar operable from (coil side) (opposite coil side) (both sides).

STOCK COLORS INCLUDE:

(22 and 24 gauge only)

White
Blue
Gray
Tan
Brown

2.02 Guides will be of roll-formed galvanized steel channel bolted to angle or structural three angle assembly of steel (stainless steel) (aluminum) to form a slot of sufficient depth to retain curtains in guides to resist 20 PSF windload. Guides may be provided with integral windlock bars and removable bottom bar stops.

2.03 Brackets will be of galvanized steel plates with permanently sealed ball bearings. Designed to enclose ends of coil and provide support for counterbalance pipe at each end.

2.04 Counterbalance: Curtain to be coiled on a pipe of sufficient size to carry door load with deflection not to exceed .03 inches per foot of door span and to be evenly balanced by helical springs, oil tempered torsion type. Cast iron barrel plugs will be used to anchor springs to tension shaft and pipe.

2.05 Hood will be minimum 24 gauge (painted) (galvanized) (slatted) steel, flanged at top for attachment to header and flanged at bottom to provide longitudinal stiffness. Hood will enclose curtain coil and counterbalance mechanism.

2.06 Finish: Shop coat of rust inhibitive primer on non-galvanized surfaces and operating mechanisms. Aluminum finish to be (mill) (204R1 clear anodized) (bronze anodized). Stainless steel finish to be (#4). Curtain will be (white) (blue) (gray) (tan) (brown).

2.07 Operation: Door will be operated by means of (manual, lift-up) (chain hoist with gear drive reduction) (awning crank) (wall crank box) (motor operation). (Electrical) (Pneumatic) sensing edge to be attached to bottom bar to (stop) (stop and reverse) the door when it contacts an object during the closing cycle.

2.08 Weatherstripping: Air-Bar/Extr-Tite doors will include flat slats, bottom astragal, exterior surface guide weatherstrip, and internal hood baffle weatherstrip.

2.09 Locking: (Manual lift-up doors will have interior slide-bolts suitable for padlocks by others.) (Chain-hoist door will have chain keepers suitable for padlocks by others.) (Electric-motor operation doors will lock through the operator gearing.) (Cylinder locks can be provided with the doors.)

CAUTION: When specifying cylinder locks on electric-motor operated doors, electric interlocks should also be specified to prevent operation when lock bolts are engaged in the guides, thus preventing damage to the curtain and/or operator.

PART 3 EXECUTION

3.01 Install the doors in accordance with Wayne-Dalton Corp. instructions and standards. Installation and maintenance will be by an authorized Wayne-Dalton representative.

Because of continuing product improvements, we reserve the right to change the product specifications and designs without prior notice.